

Instruction for HP Refillable Cartridge



1. Prepare the cartridge to be filled



2. Prepare a syringe (suggested 60ml). If the syringe is too small, then you have to fill several more times to make it full.



3. Use the syringe to draw 30ml ink.



4. Pull out the rubber seals from the Ink Filling Hole.



5. Insert the syringe into the Ink Filling Hole.



6. Pls make them join well, or It will leak air.

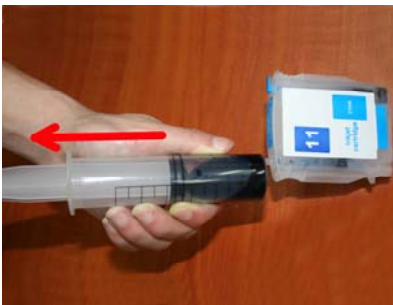

7. Draw the plunger upward (about 20ml space), then loosen it.



8. The ink will be pressed into the cartridge naturally.



9. Repeat this procedure until the cartridge is full with ink.